

SEE SHEET 18  
**PLAN: OLD NEW ROAD**  
 SCALE: 1"=50'

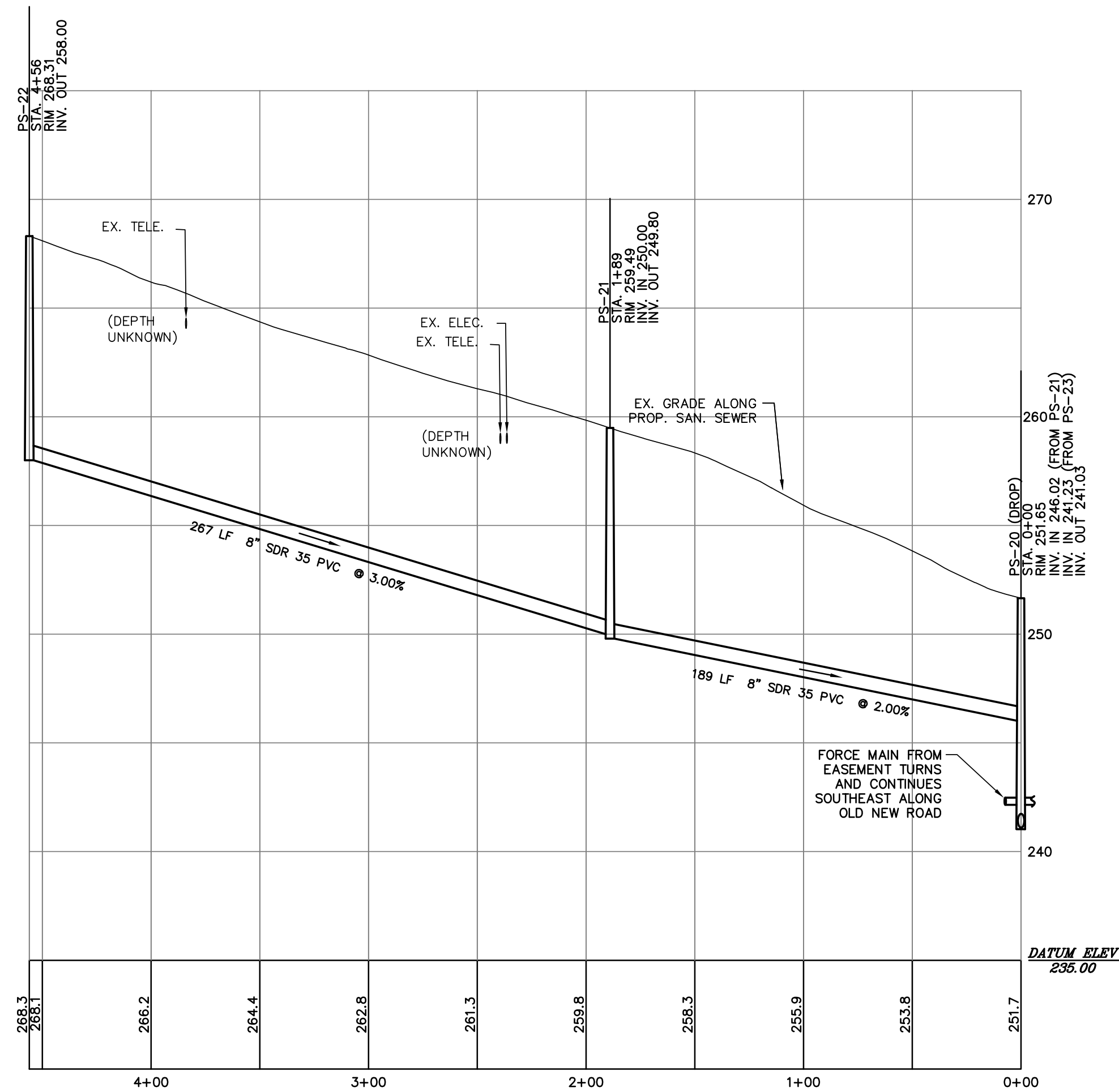

**PROFILE: OLD NEW ROAD (STA. 0+00 TO 4+56)**  
 SCALE: HORIZ. 1"=50'  
 VERT. 1"=5'

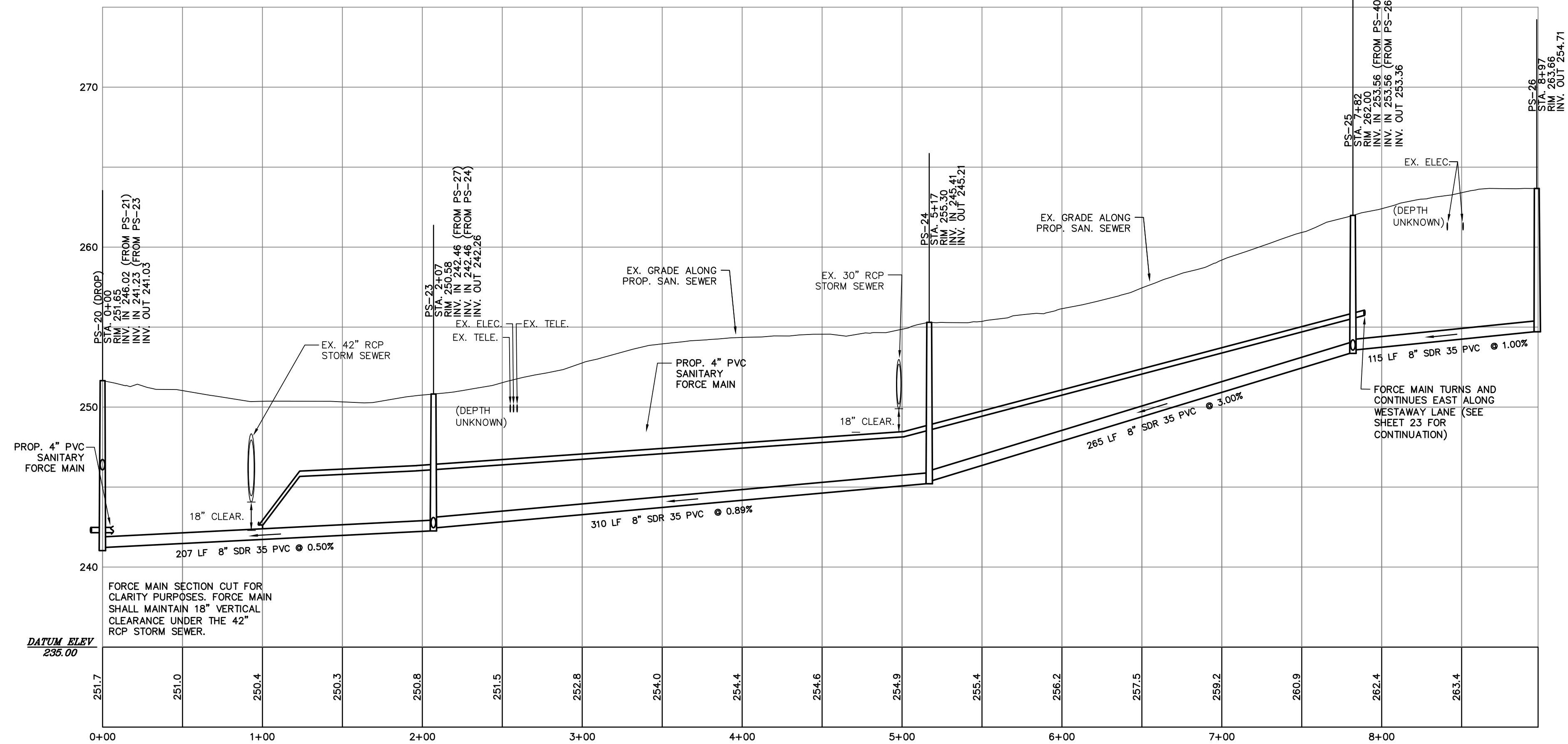

**PROFILE: OLD NEW ROAD (STA. 0+00 TO 8+97)**  
 SCALE: HORIZ. 1"=50'  
 VERT. 1"=5'

ONLY THOSE PLANS INCORPORATING THE RAISED PROFESSIONAL SEAL SHOULD BE CONSIDERED OFFICIAL AND RELIED UPON BY USER. THIS PLAN IS PREPARED SPECIFICALLY FOR THE CLIENT AND PROJECT DESIGNATED HEREON. MODIFICATION, REVISION, DUPLICATION OR USE WITHOUT THE CONSENT OF GILMORE & ASSOCIATES, INC. IS PROHIBITED. © COPYRIGHT 2015 GILMORE & ASSOCIATES, INC. ALL RIGHTS RESERVED.

LOCATIONS OF EXISTING UNDERGROUND UTILITIES/FACILITIES SHOWN HEREON HAVE BEEN DEVELOPED FROM RECORDS, FIELD MARKOUTS BY UTILITY OWNERS, AND/OR ABOVE-GROUND OBSERVATION OF THE SITE. NO EXCAVATIONS WERE PERFORMED IN THE PREPARATION OF THESE DRAWINGS; THEREFORE ALL UTILITIES SHOWN SHOULD BE CONSIDERED APPROXIMATE IN LOCATION, DEPTH, AND SIZE. THE POTENTIAL EXISTS FOR OTHER UNDERGROUND UTILITIES/FACILITIES TO BE PRESENT WHICH ARE NOT SHOWN ON THE DRAWINGS. ONLY THE VISIBLE LOCATIONS OF UNDERGROUND UTILITIES/FACILITIES AT THE TIME OF FIELD SURVEY SHALL BE CONSIDERED TRUE AND ACCURATE. COMPLETENESS OR ACCURACY OF UNDERGROUND UTILITIES/FACILITIES ARE NOT GUARANTEED BY GILMORE & ASSOCIATES, INC.

ALL CONTRACTORS WORKING ON THIS PROJECT SHALL VERIFY LOCATION AND DEPTH OF ALL UNDERGROUND UTILITIES/FACILITIES PRIOR TO START OF WORK AND SHALL COMPLY WITH THE REQUIREMENTS OF P.L. 852, NO. 287 DECEMBER 10, 1974 AS LAST AMENDED ON OCTOBER 11, 2008, PENNSYLVANIA ACT 121. GILMORE & ASSOCIATES, INC. HAS OBTAINED A PA-ONE CALL SERIAL NUMBER AS NOTED HEREON FOR DESIGN PURPOSES ONLY.

PENNSYLVANIA ONE CALL SYSTEM, INC.  
 925 Main Run Road  
 West Mifflin, Pennsylvania  
 15122 - 1078  
 PENNSYLVANIA ONE CALL SYSTEM  
 REGISTERED PROFESSIONAL ENGINEER  
 BEFORE YOU DIG ANYWHERE IN PENNSYLVANIA: CALL 1-800-242-1778. NON-MEMBERS MUST BE CONTACTED DIRECTLY BY PA LAW. PA LAW REQUIRES THREE WORKING DAYS NOTICE TO UTILITIES BEFORE YOU EXCAVATE, DRILL, BLAST OR DEMOLISH.  
**SEE SHEET NO. 1 FOR SERIAL NUMBERS**

OWNER:  
 BUCKS COUNTY WATER & SEWER AUTHORITY  
 1275 ALMSHOUSE ROAD  
 WARRINGTON, PA 18976  
 MUNICIPAL FILE NO.:  
 XX  
 REGISTERED PROFESSIONAL ENGINEER  
 ALEXANDER DYKE  
 No. 054501E  
 PENNSYLVANIA

2	ISSUED FOR CONSTRUCTION	8-3-18	JM
REV.	DESCRIPTION	DATE	BY
TAX MAP PARCEL NO.:	XX		
TOTAL AREA:	XX	TOTAL LOTS:	XX
DATE:	1-15-15	SCALE:	AS NOTED
<b>OLD NEW ROAD (STA. 0+00 TO 4+56; STA. 0+00 TO 8+97) PEBBLE RIDGE / WOODRIDGE AREA SANITARY SEWERS</b>			
DOYLESTOWN TOWNSHIP, BUCKS COUNTY, PENNSYLVANIA			
<b>GILMORE &amp; ASSOCIATES, INC.</b> ENGINEERING & CONSULTING SERVICES 65 EAST BUTLER AVENUE, SUITE 100, NEW BRIGHT, PA 19061-5108 • (215) 345-4200 • www.gilmore-assoc.com			
JOB NO.: 2013-05071			
SHEET NO.: 19 OF 32			
DESIGNED BY:	BMB/TJF/HDS/JM	DRAWN BY:	CB/BMB/TJF
CHECKED BY:	SLR		

SEE SHEET 28